

Fox Gully Bushcare Plan

Zone	Plan	Issues	Action 2011	Who
<p>Zone 1 Behind fence (road reserve) – numbers 42, 44 and 46</p>	<p>Fire break between bush & house</p> <ul style="list-style-type: none"> • Keep clear – mown/mulched 	<p>2009 - Grandis – lopped to allow recovery from lightning strike 2005 – loquat tree – professionally removed</p>	<p>BCC contractors to finish work in Zone 1C/7</p> <ul style="list-style-type: none"> • No entry agreement in-place • No action to complete weed clearance now re-infecting restored areas in Zone 7 and 15 • Golden Rain reshooting: poison/stumpgrind? 	KF
<p>Zone 2 From north of Zone 1 to fire trail</p>	<p>Allow natural regeneration</p> <ul style="list-style-type: none"> • Mulch in strips retain water • Mark out/mulch path • Monitor weeds 	<p>2008 – all Jacarandas removed 2006 - Creeping lantana – removed by hand 2006 - Succulents – removed bagged/binned 2005 - Umbrella trees, Chinese Elm, Queens palms – professionally removed – mulch retained</p>	Monitoring weeds	MF
<p>Zone 3 Slope to east – Len’s yard to steps and down to track Refer Appendix B & C</p>	<p>Replant</p> <ul style="list-style-type: none"> • Prepare area/safety • remove final weeds • remove dead trees <p>Maintenance/weeding</p>	<p>2008 – Jacaranda trees removed 2008 – Infection of white Wandering Jew – 2 cu metres removed and composted onsite 2007 – re-planted 2007 – purple succulents – removed & mulched (mower) 2007 dead trees & Dragon fruit – falling risk - removed 2006 – Yellow Oleander & Creeping lantana – removed</p>	<p>Monitor weeds</p> <p>Dragon fruit high in Tallowwood – poison with 50% glyphosate/water – in-place 2009 – monitor</p>	MF

Fox Gully Bushcare Plan

Zone	Plan	Issues	Action 2011	Who
Zone 4 Old bamboo area	Allow natural regeneration <ul style="list-style-type: none"> • remove bamboo • logs on slope for erosion control • monitor weeds 	2008 – Jacaranda trees removed 2006 – bamboo removed & mulched – roots dug out 2006 – concrete/rubbish removed	Monitor weeds	MF
Zone 5 North of Zone 4 to culvert – fire trail to half way down slope Example site for natural regeneration	Allow natural regeneration <ul style="list-style-type: none"> • hand removal of weeds • logs on slope for erosion control 	2007 – Creeping lantana, molasses grass, corky passion vine – removed by hand/mulched	Monitor weeds	MF
Zone 6 Rocky area at curve of fire trail, down to slope to west and north to curve in fire trail	Allow natural regeneration <ul style="list-style-type: none"> • hand removal of weeds • monitor weeds 	2008 – creeping lantana, cobbler's pegs 2007 – Creeping lantana (mulched) mother or millions (bagged/binned)	Monitor weeds Continue removal of Creeping lantana, cobbler's pegs further down western slope	MF

Fox Gully Bushcare Plan

Zone	Plan	Issues	Action 2011	Who
<p>Zone 7 Agave area – rear of #44 beside fire road</p>	<p>Replant</p> <ul style="list-style-type: none"> • Prepare area/safety • Remove Agave • Remove and chip Chinese Elm and umbrella trees • remove bricks, rubbish • fill cut behind #42 (also covering old garden waste) 	<p>2010 – Imperial Hairstreak butterflies returned and Noisy Minor nesting 2008 – replanted October 2008 – gardens/brick edging removed – plants bagged and binned – soil used to start filling cut behind #42</p> <p>Negotiate with neighbours – Done</p> <ul style="list-style-type: none"> • Edek & Cynthia # 42 – ok to remove Golden Rain tree, Agave, Umbrella tree & clean up • Sandra # 44 – ok to remove Agave, bricks, umbrella trees <p>2007 – Loquat tree removed & mulched, rubbish removed, agaves removed and binned</p>	<p>Monitor weeds – some difficulty with access behind #42 – agreed with Kylie Dennis not to enter area immediately behind #42</p>	<p>MF</p>

Fox Gully Bushcare Plan

Zone	Plan	Issues	Action 2011	Who
Zone 8 Gully below track level – Len’s yard to culvert	Access difficult – steps/track inplace for ongoing access Clear Fishbone fern, Cassia, ochna, queens palm, Chinese elms, Oleander, creeping lantana, purple succulent, camphor laurel, bamboo Selective replanting to restore tree ferns originally in gully	2010 – Purple Succulent clearing completed by neighbours- some replanting 2009 – ANZ team first stage removal Purple Succulent 2008 – Jacaranda trees removed/poisoned 2007 – logs placed on slope below Zone 4 – stabilised and improved access 2006 – bamboo removed & mulched	Monitor weeds in restored areas. Continue clearing upstream – ANZ team? Remove remaining bamboo as priority	MF MF MF
Zone 9 Gully upstream of culvert	Allow natural regeneration <ul style="list-style-type: none"> • hand removal of weeds • monitor weeds • protect cleared slope from erosion – logs pegged in place 	2007 – Fishbone fern, ochna, Chinese elm, stinking passionfruit, creeping lantana	Continue removing fishbone fern	MF
Zone 10	Monitor for future action – natural regeneration	Cobblers Pegs, Creeping Lantana and StPauls Wort	Monitor major infestations	MF

Fox Gully Bushcare Plan

Zone	Plan	Issues	Action 2011	Who
Zone 11	Monitor for future action – natural regeneration	Creeping Lantana	Monitor major infestations	MF
Zone 12	Natural regeneration	Cable drum Creeping lantana	BCC contractor to remove cable drum	KF
Zone 13	Natural regeneration once Fishbone removed	Large infestation of Fishbone Fern – not able to compost - bag and remove off-site	FWR Group – four dates looked-in BCC pick-up of weeds after FWR visits	MF KF
Zone 14 Top o	Restoration replanting once weeds/rubbish removed Firebreak planting	2010 – Stage 2 planting October 2010 – four truckloads weeds/rubbish removed stage 2 2010 – Imperial Hairstreak butterflies returned 2009 – Stage 1 planting October 2008 – Cadgai trees removed	Stage 3 restoration – remove weed trees, remainder of Singapore Daisy Stage 3 – re-planting – October 2011	MF
Zone 15A Behind #38 - 40 O'Grady St	Firebreak planting and natural regeneration	Some weed regrowth Creeping Lantana to be cleared	Manage weed regrowth Clear Creeping Lantana	MF
Zone 15A Behind #36 O'Grady St	Restoration of water course to original path. Replanting with Lomandras, tree ferns, native grasses	Water diverted onto and eroding access track. Limited access for mulch delivery. Major infestation of Singapore Daisy and Brazilian Pepper Tree	Remove Sing Daisy and compost on-site. Establish <i>Oplismenus aemulus</i> fast to manage weeds.	MF

Fox Gully Bushcare Plan

Zone	Plan	Issues	Action 2011	Who
<p>Zone 16</p> <p>Top of Azania Street – on right just inside Reserve</p> <p>Start of wildlife corridor to Klump Rd</p>	<p>Ideal picnic area - ferny gully</p> <p>Progressively clear Cadgai as replacement trees grow – current trees act as wind break for houses</p>	<p>Ongoing garden waste dumping – significantly reduced but still some dumping</p>	<p>Clear Singapore Daisy, Coral Ginger, Fishbone, Mother of Millions</p> <p>BCC contractor to remove first group of Cadgai and Umbrella Trees</p>	<p>BE/MF</p> <p>KF</p>
<p>Gully Stewardship Zones – Wildlife Corridor</p> <p>O’Grady St #48, 50, 52, 62, 64 & 68</p>	<p>Private property zones – gully easement – Small Allotment Land-for-Wildlife agreements</p>	<p>Most people not actively using gully portion of their properties.</p>	<p>Engage neighbours both sides of gully – map on Google Earth</p> <p>Draft Wildlife agreement</p>	<p>MF</p> <p>MF</p>
<p>Site Masterplan</p>	<p>Progress reporting</p> <p>Education/Public relations</p> <p>Access track erosion</p>	 <p>Polluting water flowing gully</p>	<p>Bushcare signs</p> <p>Fox Gully Updates</p> <p>Fox Gully blog</p> <p>Southside News articles</p> <p>BOIC visit</p> <p>Mulch filters at track run-off points</p>	<p>MF</p> <p>MF</p> <p>MF</p> <p>MF</p> <p>SJ/MJ</p> <p>MF</p>

MF Michael Fox – 0408 769 405
 SJ Susan Jones
 KF Kate Flink

Fox Gully Bushcare Plan

Appendix A – Zone Map

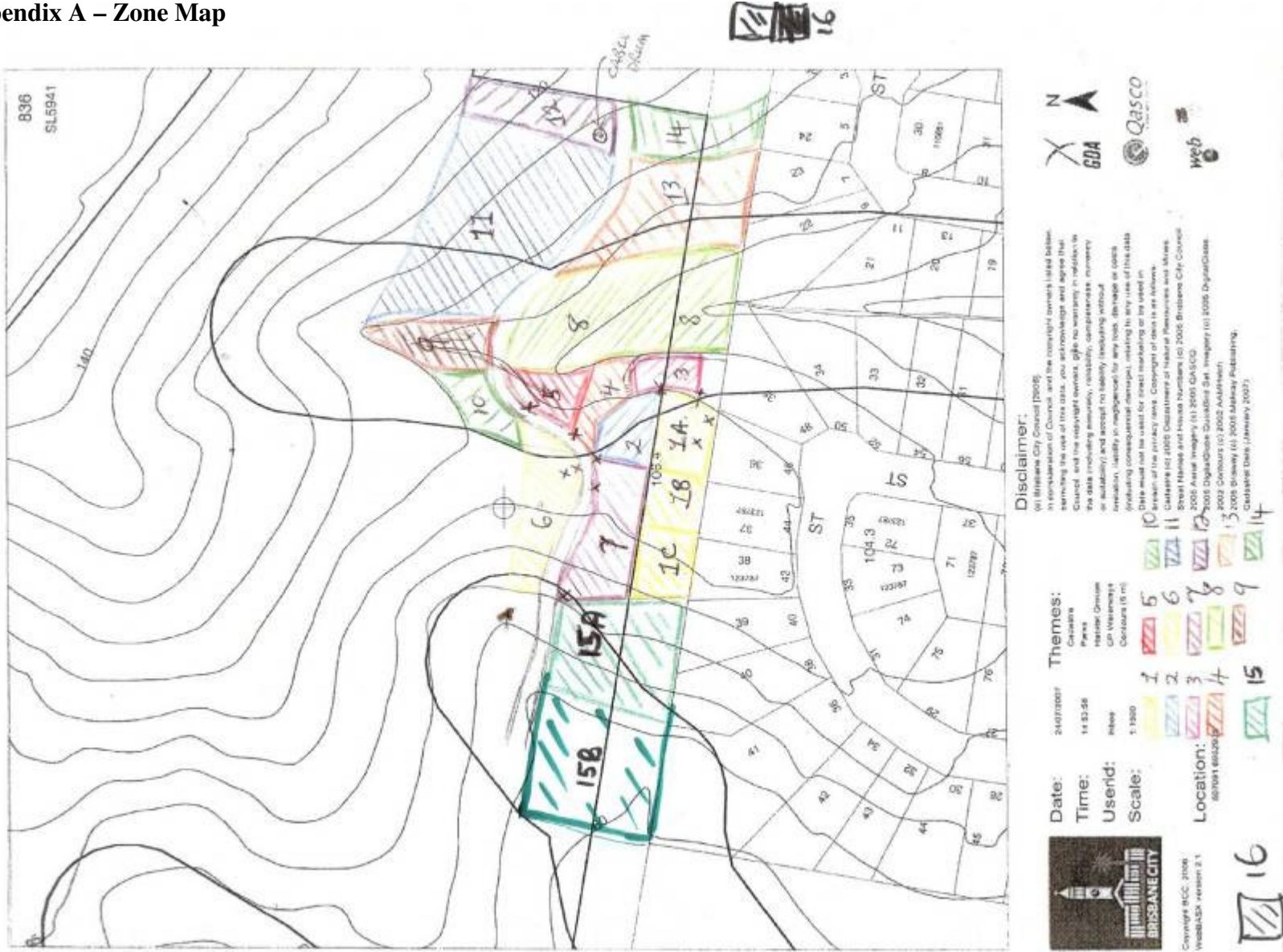

Fox Gully Bushcare Plan

Appendix B – Wildlife Corridors

Roly Chapman Reserve Bushcare
Links to Mt Gravatt Reserve

